



┌
Kanteen

Canteen └



:

IT'S HAPPENING
A LOT OF THINGS AT THE SAME TIME
TRUCKS, CARS, BIKES, MATERIALS, PEOPLE.
ALL MOVING TO ONE MOMENT, FOR ONE PURPOSE
WHEN YOU CROSS THEM, WHEN YOU SEE THEM PASSING, YOU KNOW THEY
ARE WORKING SOMEWHERE,
YOU TRY TO FIGURE OUT. THIS CREW ARE THEY BUILDING THE ORANGE
ARENA ?

THERE IS ONE MEETING POINT TO ALL OF US
ESSENTIAL ONE THAT STRUCTURE OUR DAILY SCHEDULE
A PLACE WHERE PEOPLE GATHER IN CREW COME EVERYDAY
WE ALL STOP OUR WORK TO COME AND EAT

7.00 TO 9.00
12.30 TO 14.00
18.30 TO 20.00

BETWEEN, THE COOKING CREW IS WORKING TO MAKE IT POSSIBLE
TO PREPARE FOOD FOR ALL THE VOLUNTEERS, AROUND 30 000 DURING THE
FESTIVAL.

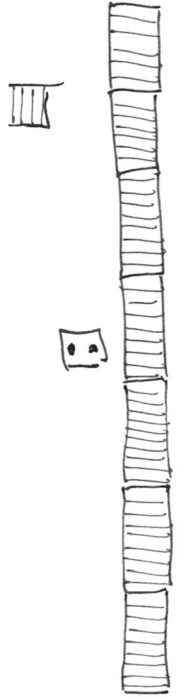

EATING TABLES

CLEANING TABLE

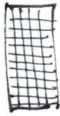

CLEANING TABLE



BUFFET TABLES

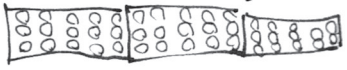

EATING TABLES



COFFEE TABLE



ENTRANCE TABLE



WATER/SUICE TABLE

A MASTER CLASS IN TABLES

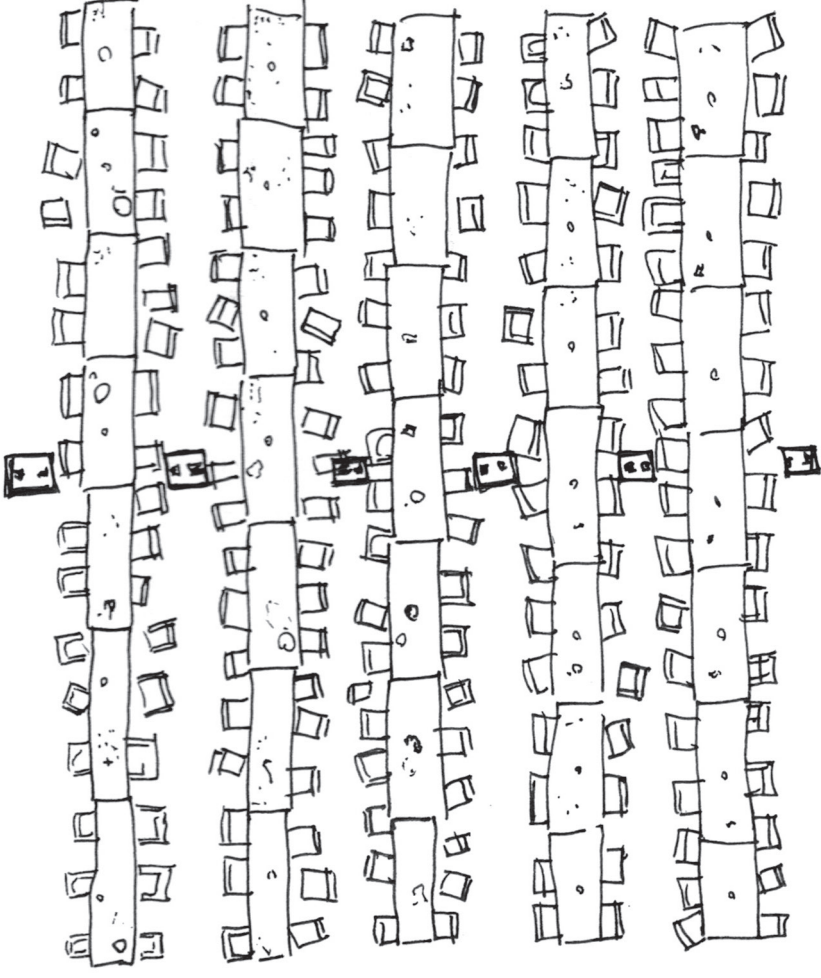

WE ARE CLOSED

15,000 01.07.18

SITTING WITH
YOUR CREW

12h54

30.06.18

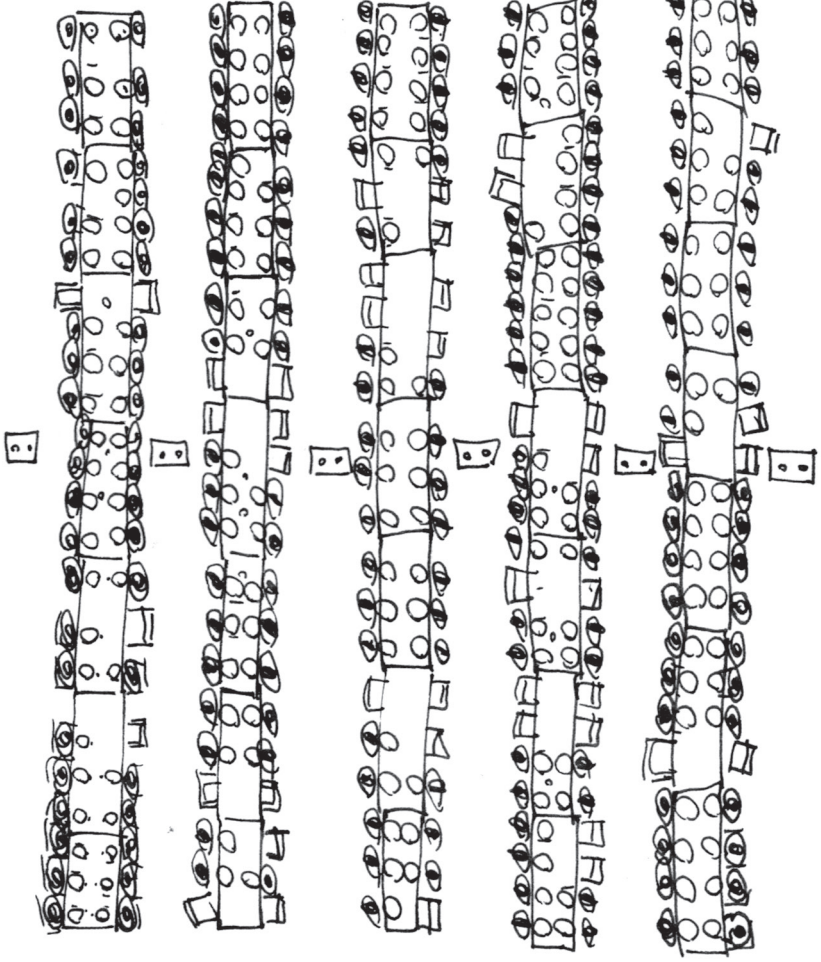

IN.
SKIN

OUT

KANTEEN

SKY

CAN YOU SEE THE SKY FROM THE ROOF ?
CAN YOU HEAR THE SEAGULLS OUT THERE ?
HOW CAN WE HEAR THE SEAGULLS OUT WITH SUCH MASSIVE BUBBLE OF
NOISE IN ?
CAN YOU HEAR ME WHEN I SPEAK TO YOU ?
DID YOU NOTICE THE WHITE CURTAINS ?
ARE THEY BREAKING THE SUN LIGHT ENTERING BY THE WINDOWS ?
DID YOU SEE THE LAMP'S GUIRLANDE ?
DID YOU NOTICE THE HUGE SIZE PICTURES OF ROSKILDE CROWD ?
DO YOU FEEL THE ROOF AS A THIN SKIN ?
DO YOU HAVE THE IMPRESSION YOU COULD FEEL THE WIND ?

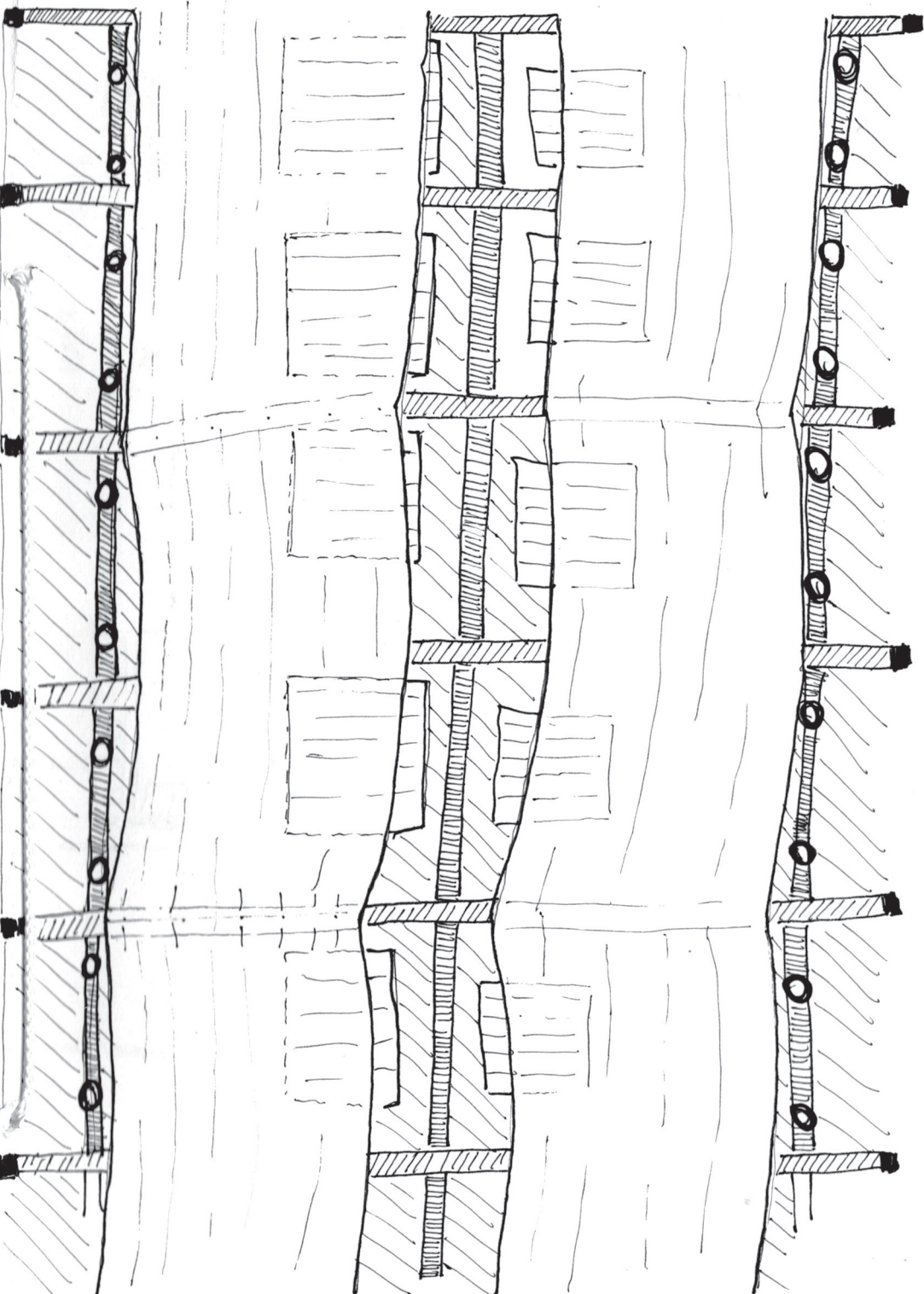

13h55

01.07

KITCHEN
TO SERVICE

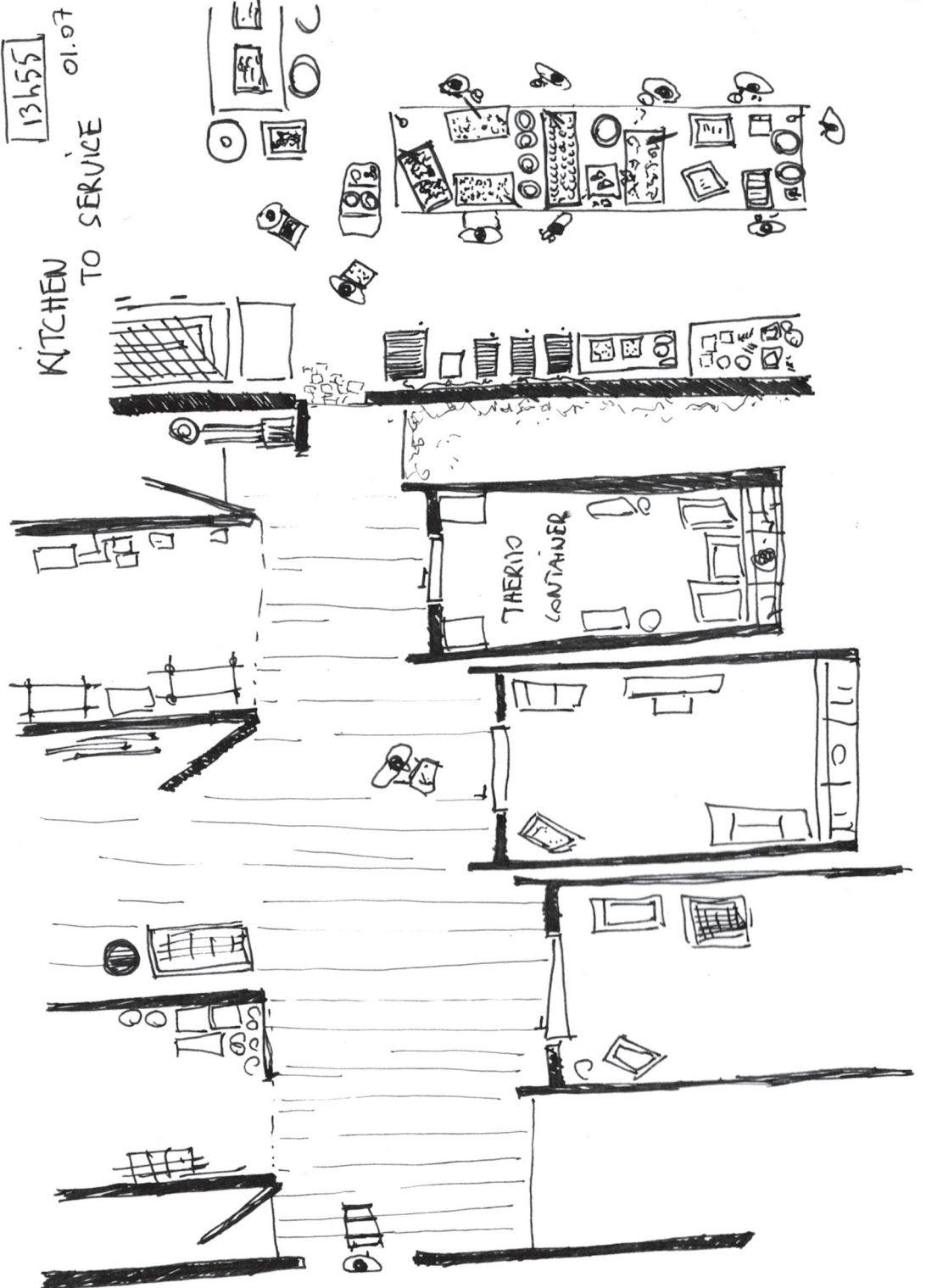

HAL 4 ENTRANCE

BREAKFAST

8h 34 / 8h 38

29.06.16

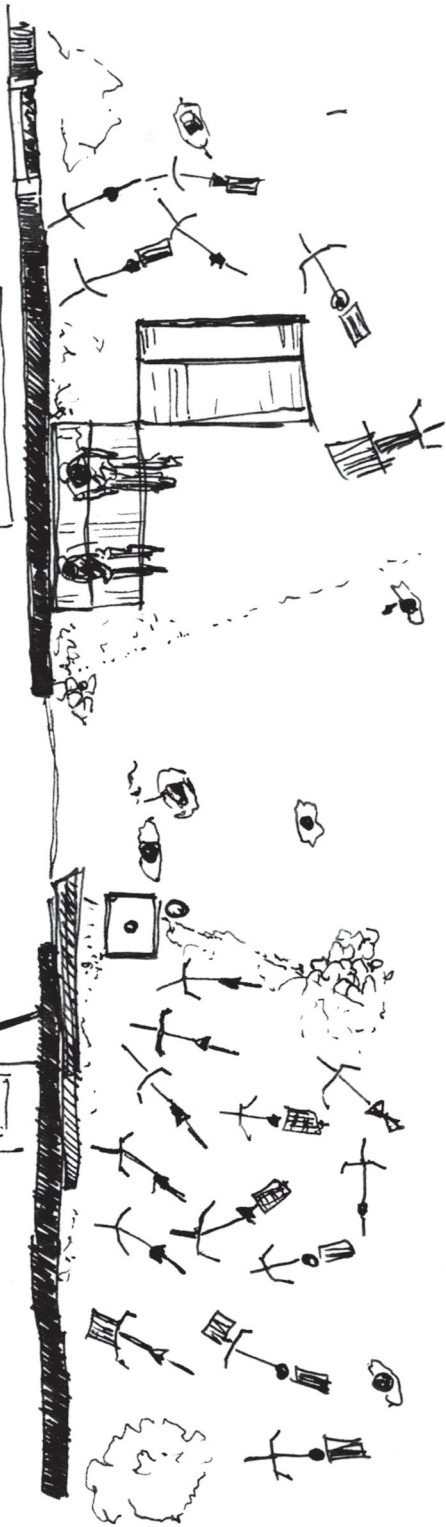
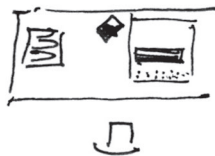
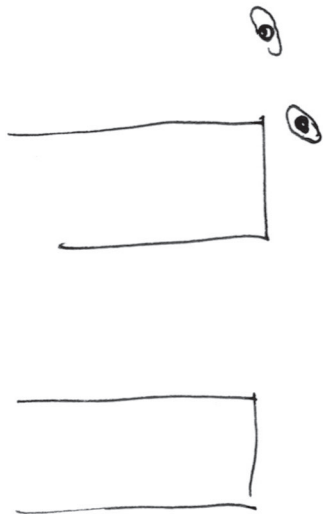

HAL 4 ENTRANCE

03.07.18

9h30

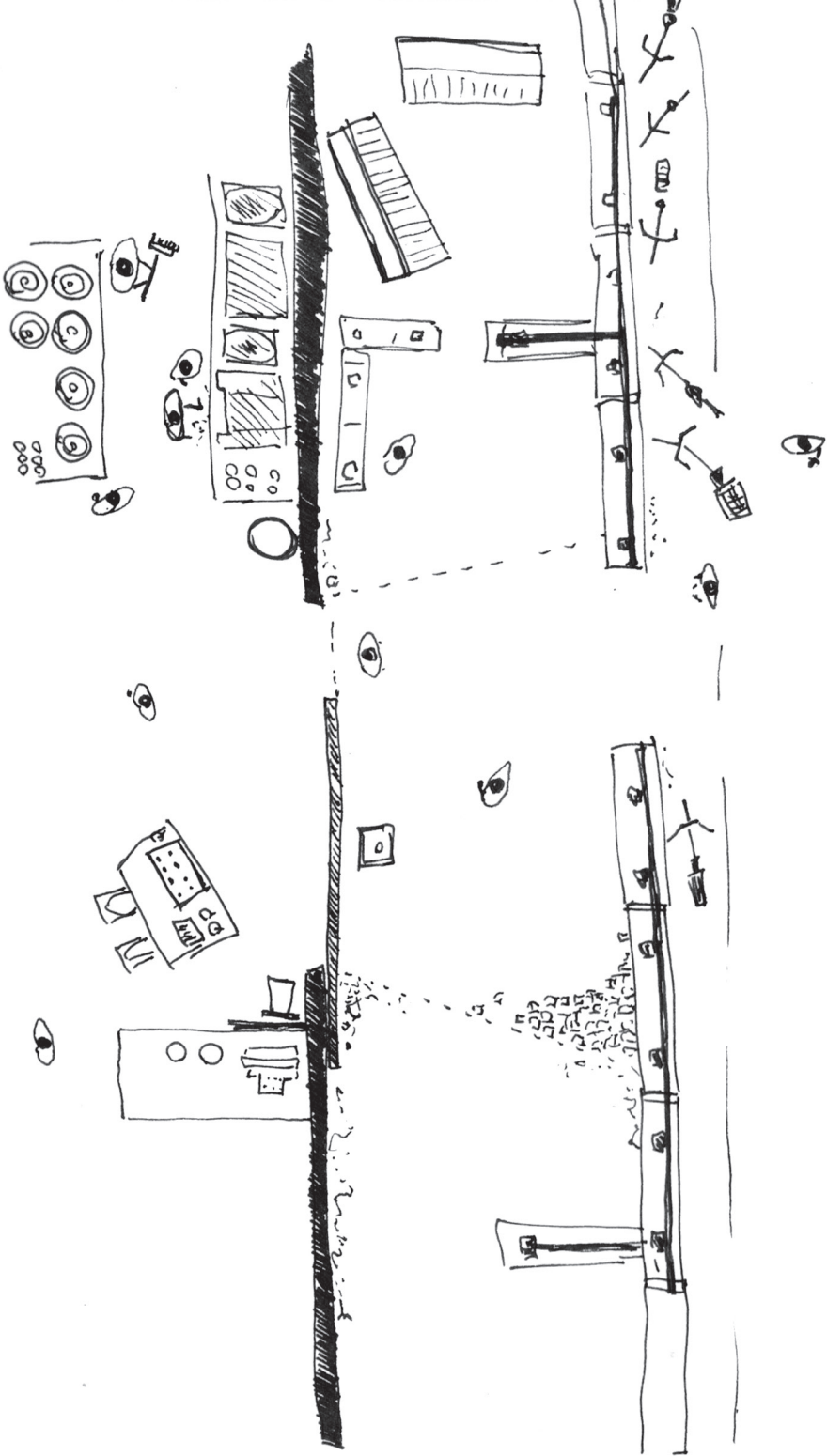

04.07.16
12h46

HAL 4
ENTRANCE
CLOSED

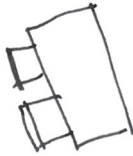
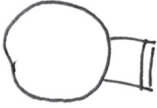
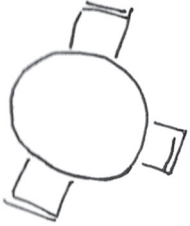

GO TO HAL 3
TO PICK UP FISON



'TEMPORARY COMMONS'
THE SHOOL FOR CIVIC ACTION
Summer School at Roskilde Festival 2018

-
Mapping the canteen

-
Mathéo fradet